

How to configure lighting control for a courtyard setting

Before using the cheat sheet, please make sure you have the basic Casambi App knowledge for creating a network, pairing devices, creating groups and enabling control hierarchy. For more information, please refer to the tutorial videos on: <https://casambi.com/training/>

Scenario

Courtyard

- A courtyard where all lights are automatically dim up to 100% at sunset -10 minutes with a very slow fade time (10min).
- (22:00-00:00): Motion detection triggers all lights to 100%. If sensors have not detected movement for 10 minutes, lights are dimmed to 50%. In the absence of movement for another 10 minutes, lights are dimmed to 20%.
- **After midnight:** All lights are switched off and turned on only if movement is detected.

Key Programming Overview

4 Scenes

- **OFF:** All lights are off.
- **ON 20:** All lights are on at 20%.
- **ON 100:** All lights are on at 100%.
- **Absence:** All lights are set to 50%.

3 Timers

- All days, ON at Sunrise, OFF not set (override presence): Triggers the **OFF** scene.
- All days, ON at Sunset -10, OFF at 22:00 (override presence): Triggers the **ON 100** scene.
- All days, ON at 22:00, OFF at 00:00: Triggers the **ON 20** scene.

Sensors

Presence/Absence mode:

- Presence triggers the **ON 100** scene.
- After the linger time, Absence triggers the **Absence** scene. Absence timeout is also active and set for 10 minutes.
- Between 22:00 and 00:00 the lights will then go back to the **ON 20** scene after Absence timeout expires. After 00:00 lights will fade off.

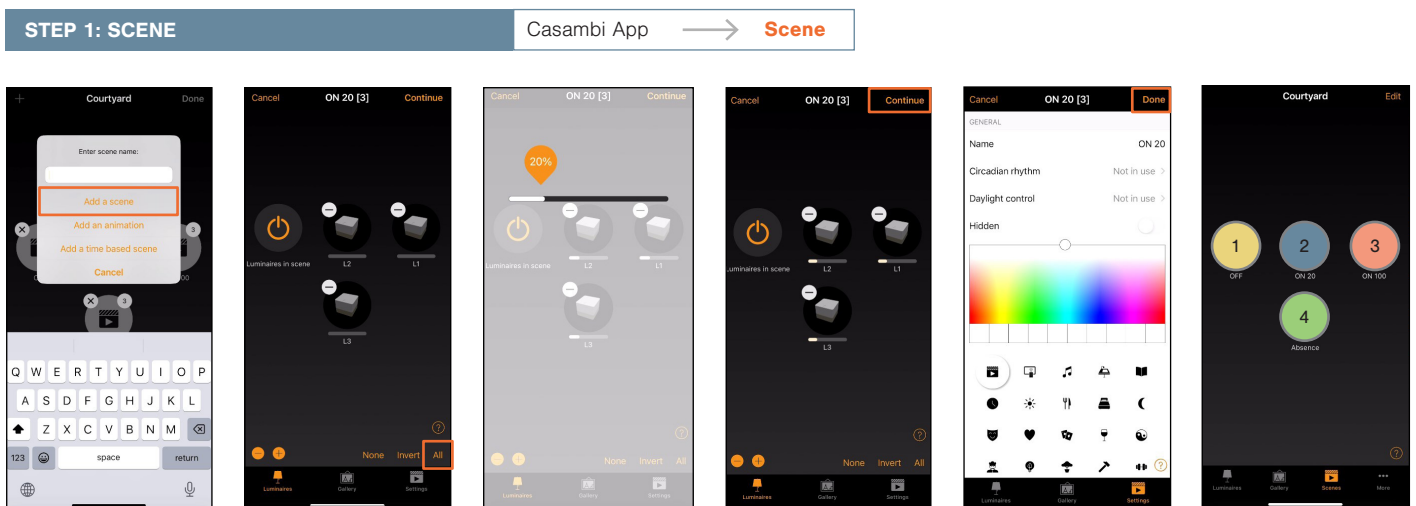

Repeat this process to create the 4 scenes:

- 1 **OFF:** Set all luminaires to 0%.
- 2 **ON 20:** Set all luminaires to 20%.
- 3 **ON 100:** Set all luminaires to 100%.
- 4 **Absence:** Set all luminaires to 50%.

STEP 2: SENSOR

Casambi App → More → **Sensor**

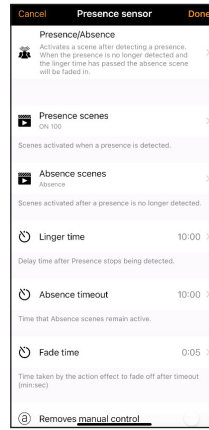
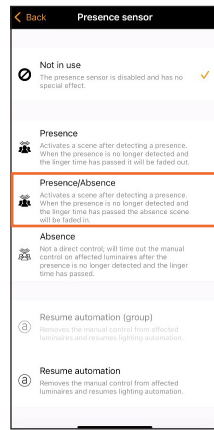
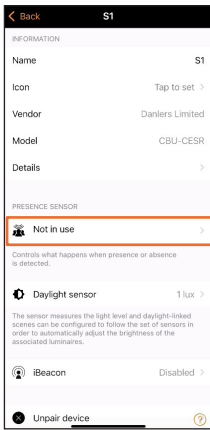

Select the **ON 100** scene that will be activated when presence is detected.

Select the **Absence** scene.

The **ON 100** scene will be faded out after 10 minutes passed without detecting presence.

Absence scene will be activated after linger time has expired. The absence timeout is set to 10 minutes.

5 seconds is the time to dim to off or to fade into the Absence scene.

STEP 3: TIMER

Casambi App → More → **Timer**

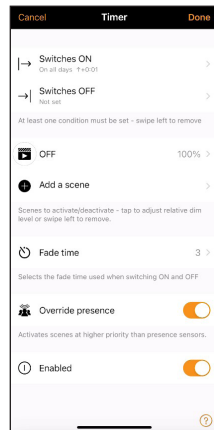
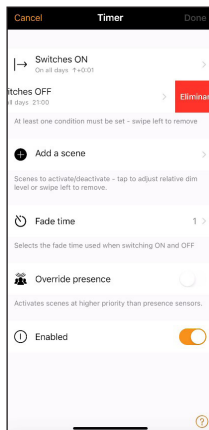
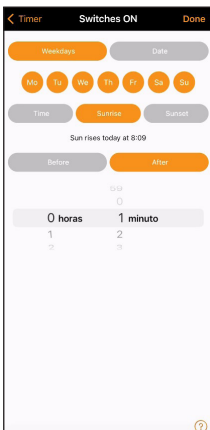

Switches ON: Weekdays, Mo-Su, Sunrise, After 1 minute

Switches OFF: Not set

Select the **OFF** scene. The light level applies to the scene selected. e.g., light level set as 10% and the scene is 50%, then the luminaires level will be restricted to 5%.

Time it will take for the luminaires in the scene to reach their defined light level. Fading will start when the timer is activated. In this case, the luminaires will take 3 seconds to fade in /out.

Enable **Override presence**. The timer will have higher priority over presence.

Select **Enabled** button.

It is necessary to set **Location** to use sunrise and sunset times.

Create the other times according to the following configurations:

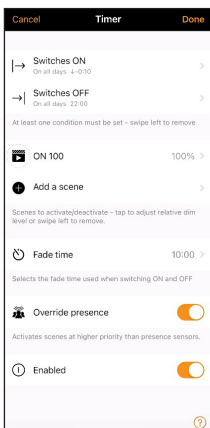

Switches ON: Weekdays, Mo-Su, Sunset, Before 10 minutes

Switches OFF: Weekdays, Mo-Su, Time, 22:00

Select the **ON 100** scene.

Set 10 minutes.

Enable **Override presence**.

Select **Enabled** button.

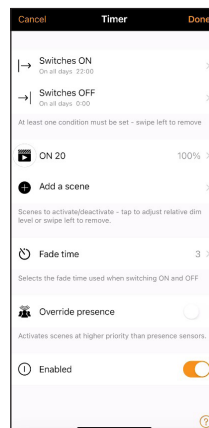

Switches ON: Weekdays, Mo-Su, Time, 22:00

Switches OFF: Weekdays, Mo-Su, Time, 00:00

Select the **ON 20** scene.

Set 3 seconds.

Disable **Override presence**.

Select **Enabled** button.

A timer between 00:00 and sunrise is not needed. The lights will be off and only will turn on when movement is detected, triggering Presence/Absence mode.