

How to configure lighting control for a retail setting

Before using the cheat sheet, please make sure you have the basic Casambi App knowledge for creating a network, pairing devices, creating groups and enabling control hierarchy. For more information, please refer to the tutorial videos on: <https://casambi.com/training/>

Scenario

Small high-street store

- **Everyday:** All lights - All days: (09:00-20:00) Daylight scene - lights fade up to a set level when measured daylight level falls below preset threshold value (1000 lx).
- **Store closed:** All lights - All days: (20:00-00:00) Lights on at 70%.
- **Late hours:** Shop window lights - All days: (00:00-09:00) Occupancy detection - lights on at 100% when presence is detected in front of the shop window. No occupancy for 5 mins, lights are switched off.

Key Programming Overview

3 Scenes

- **Everyday** - Daylight scene (Basic ON/OFF mode)
- **Closed**
- **Late hours**

2 Timers

- **All days ON 9:00 - OFF not set (override presence):** Triggers the **Everyday** scene.
- **All days ON 20:00 - OFF 00:00 (override presence):** Triggers the **Closed** scene.

STEP 1: SCENE

Casambi App → **Scene**

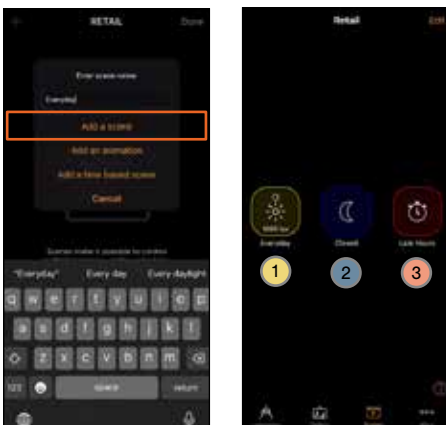

In the **Scene** tab, create the 3 scenes:

- 1 **Everyday:** Set all luminaires to 100%.
- 2 **Closed:** Set all luminaires to 70%.
- 3 **Late hours:** Set shop window luminaires to 100% and sales area to 0%.

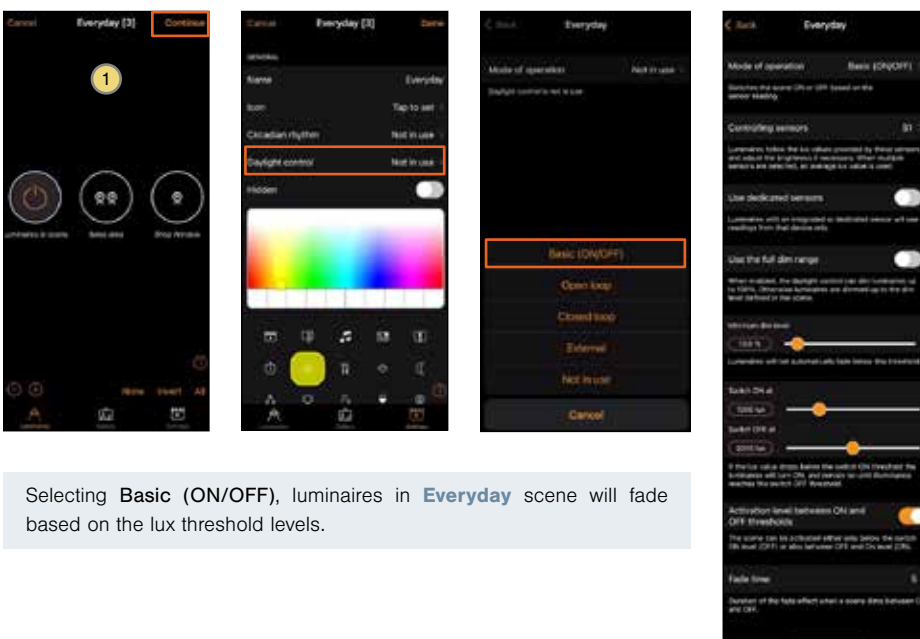

Select the sensor that will provide the lux level for the luminaires.

The lights will be faded to the minimum dim level (10%) when measured lux is above **Switch OFF at**. The Minimum dim level is relative to the scene dim level (i.e. if Minimum dim level is 10% and the scene is at 50% then the minimum dim level will be 5%).

The lights will be ON when the measured lux is below 1000 lux.

If the measured lux is above 2000 lux, the lights will be faded to the Minimum dim level setting (10%).

Enabling this button, the scene will be set to switch on when the scene is triggered and is between the minimum and maximum defined lux thresholds.

5 seconds is the time for the luminaires in the scene to reach their defined light level.

STEP 2: SENSOR

Casambi App → More → **Sensor**

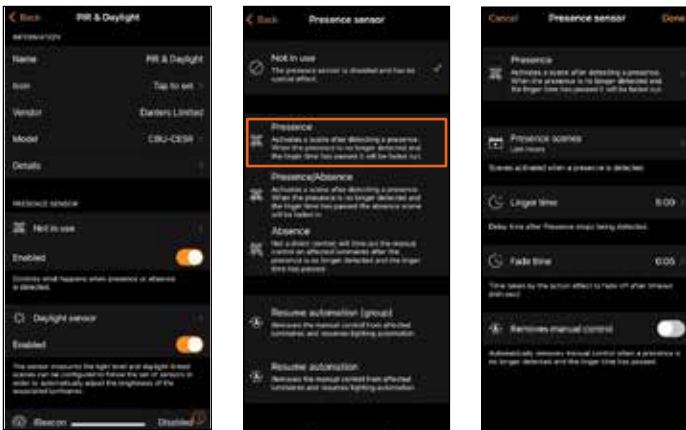

Select the **Late hours** scene. The sensor will trigger this scene when presence is detected.

After 5 minutes passed without detecting presence, the scene will be faded out.

In this case, the fade off action will take 5 seconds.

STEP 3: TIMER

Casambi App → More → **Timer**

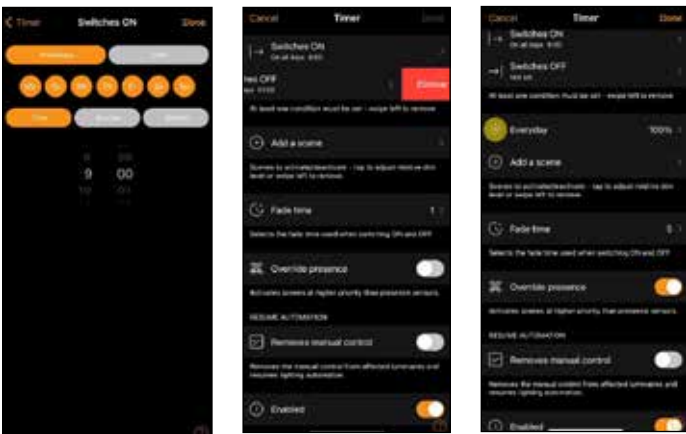

Switches ON: Weekdays, Mo-Su, 9:00

Switches OFF: Not set. Since both timers contain the same luminaires, it's not necessary to set the **OFF** time for the 1st timer.

Select the **Everyday** scene. The light level applies to the scene selected. e.g., light level set as 10% and the scene is 50%, then the luminaires level will be restricted to 5%.

Time it will take for the luminaires in the scene to reach their defined light level. Fading will start when the timer is activated. In this case, the luminaires will take 5 seconds to fade in /out.

Enable **Override presence**. The timer will have higher priority over presence.

Select **Enabled** button.

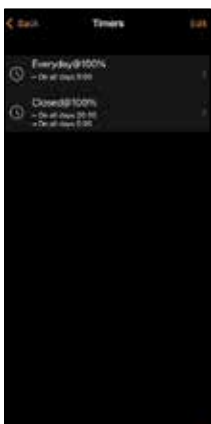

A timer between 00:00 and 09:00 is not needed because **Presence** will always try to activate the **Late hours** scene every time it is triggered, but this scene will only be visible when timers with **Override Presence** have switched off (priority in the Control Hierarchy).